

PS1X Price Computing Scale

Technical Manual

Pinnacle Technology Corp.

CONTENTS

1	PS1X EXPLODED VIEWS	1
1.1	PS1XA	1
1.2	PS1XB.....	2
1.3	PS1XC.....	3
1.4	PS1XD	4
1.1	PS1XD-Pole.....	5
2	ERROR CODE WARNING	6
3	SEALING OPERATION METHOD and ACCELERATION of GRAVITY ADJUSTMENT	6
3.1	Destroy the sealing.....	6
3.2	The methods of gravity acceleration compensation value adjustment.....	8
3.3	The methods of label sealing after amending.....	8
4	ZERO/FULL WEIGHT LEARNING METHODS	9

1 PS1X EXPLODED VIEWS

1.1 PS1XA

➤ Stainless steel platter

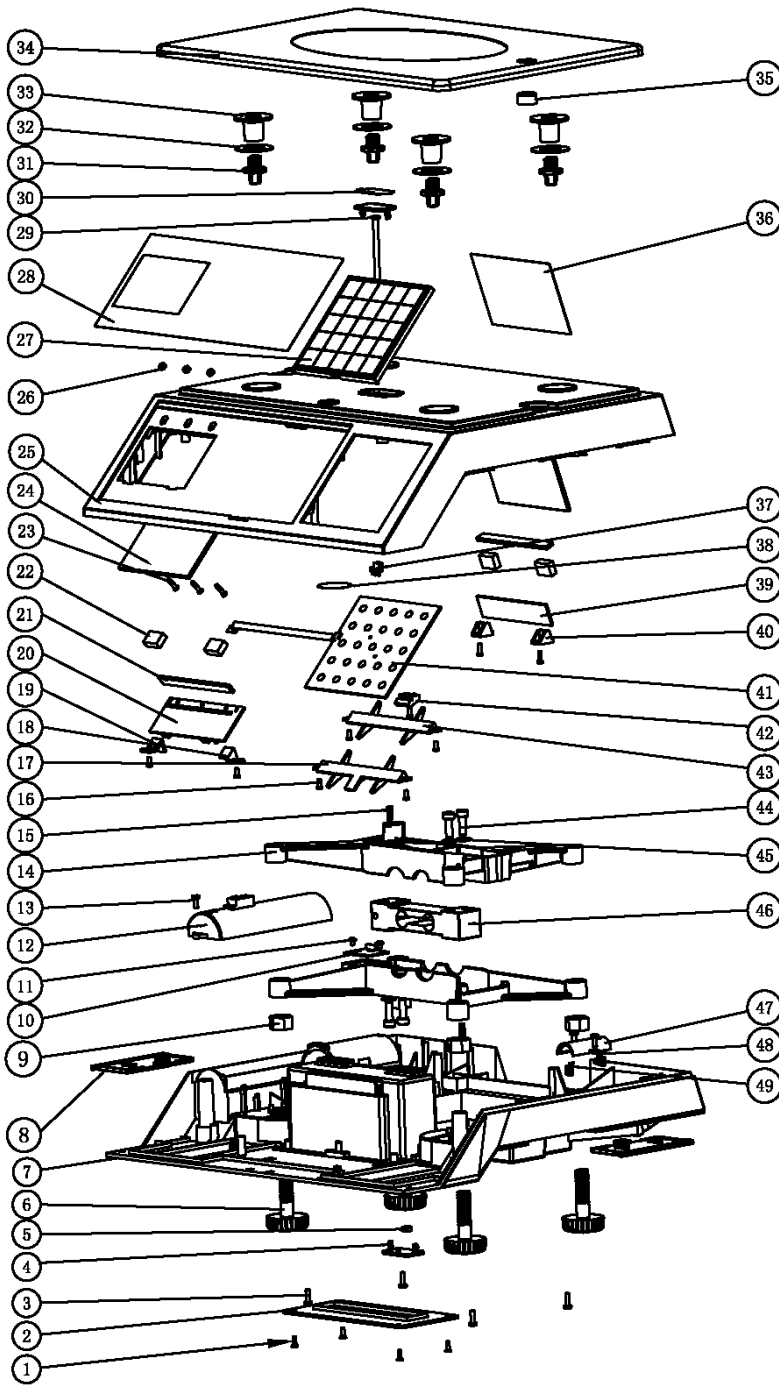

49	PS1-A-49	positive spring	1	
48	PS1-A-48	Negative spring	1	
47	PS1-A-47	No.5 battery jar bottom	1	
46	PS1-A-46	Sensor	1	
45	PS1-A-45	Spring washer M6.0	4	
44	PS1-A-44	Socket hexagon cap screw M6.0*25	4	
43	PS1-A-43	Key support bar 2	1	
42	PS1-A-42	button press block	1	
41	PS1-A-41	keyboard group	1	
40	PS1-A-40	customer display press block	2	
39	PS1-A-39	customer display group	1	
38	PS1-A-38	buzzer	1	
37	PS1-A-37	prevent cheating switch group	1	
36	PS1-A-36	Customer display	1	
35	PS1-A-35	Gradienter D14.8X8.3	1	
34	PS1-A-34	stainless steel platter	1	
33	PS1-A-33	pan locating pin	4	
32	PS1-A-32	Anti-insect slice	4	
31	PS1-A-31	adjustable bolt	4	
30	PS1-A-30	sealing fragile table	1	
29	PS1-A-29	Machine tooth M4.0X78FMIHC	1	
28	PS1-A-28	Store display + back up plate	1	
27	PS1-A-27	Silicon rubber keypads	1	
26	PS1-A-26	hexagon nut M2.5	3	
25	PS1-A-25	Upper cover	1	
24	PS1-A-24	LCD display	2	
23	PS1-A-23	Machine tooth screws 2.5X11PMHC	3	
22	PS1-A-22	LCD spacer	4	
21	PS1-A-21	conductive rubber BY579X8X2.5B-0.1	2	
20	PS1-A-20	Main board group	1	
19	PS1-A-19	store display press block left	1	
18	PS1-A-18	store display press block right	1	
17	PS1-A-17	Key support bar 1	1	
16	PS1-A-16	tapping screw 2.6*6 PBHC	9	
15	PS1-A-15	Socket hexagon cap screw M4.0*12H0	2	
14	PS1-A-14	aluminum alloy post	2	
13	PS1-A-13	tapping screw 3*8PBHC	4	
12	PS1-A-12	No. 1 battery jar bottom	1	
11	PS1-A-11	Machine tooth screws 2.5X4PWCTTHZN	2	
10	PS1-A-10	HX710-AD board group	1	
9	PS1-A-9	hexagon nut M10	4	
8	PS1-A-8	dry battery cover	2	
7	PS1-A-7	Low cover	1	
6	PS1-A-6	scale pads	4	
5	PS1-A-5	Nut M4.0	1	
4	PS1-A-4	sealing cover	2	
3	PS1-A-3	Machine tooth screws 3.0*12	4	
2	PS1-A-2	storage battery cover	4	
1	PS1-A-1	sunk screw 2.6X8	4	
NO.	Part No.	Part name	Qty	Remark

1.2 PS1XB

➤ Stainless steel platter

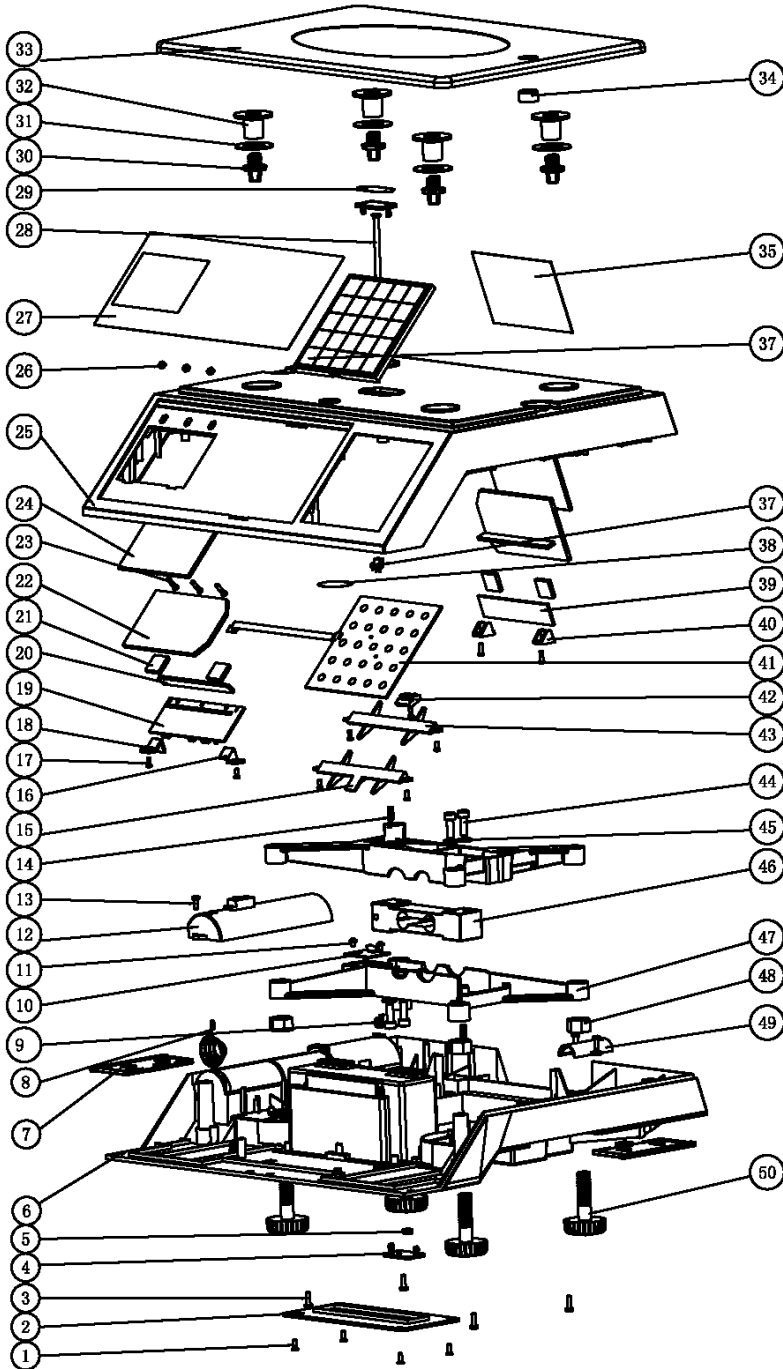

50	PS1-B-50	Scale pads	1	
49	PS1-B-49	No.5 battery jar bottom	1	
48	PS1-B-48	hexagon nut M10	4	
47	PS1-B-47	aluminum alloy post	2	
46	PS1-B-46	sensor	1	
45	PS1-B-45	Spring washer M6.0	4	
44	PS1-B-44	Socket hexagon cap screw M6.0*25	4	
43	PS1-B-43	Key support bar 2	1	
42	PS1-B-42	Button press block	1	
41	PS1-B-41	keyboard group	1	
40	PS1-B-40	customer display press block	2	
39	PS1-B-39	customer display board group	1	
38	PS1-B-38	Buzzer D27	1	
37	PS1-B-37	prevent cheating switch group	1	
36	PS1-B-36	silicon rubber keypads	1	
35	PS1-B-35	customer display	1	
34	PS1-B-34	gradienter D14.8X8.3	1	
33	PS1-B-33	stainless steel platter	1	
32	PS1-B-32	pan locating pin	4	
31	PS1-B-31	anti-insect slice	4	
30	PS1-B-30	adjustable bolts	4	
29	PS1-B-29	sealing fragile label	1	
28	PS1-B-28	Machine tooth screws M4.0X78FPMHC	1	
27	PS1-B-27	Store display + back up plate	1	
26	PS1-B-26	hexagon nut 0M2.5	3	
25	PS1-B-25	Upper cover	1	
24	PS1-B-24	LCD	2	
23	PS1-B-23	Machine tooth screws 2.5X11PMHC	3	
22	PS1-B-22	back light group	2	
21	PS1-B-21	PTI rubber pads 15*15*T3	4	
20	PS1-B-20	Conductive rubber BYS79X8X2.5B-0.1	2	
19	PS1-B-19	Main board group	1	
18	PS1-B-18	store display press block left	1	
17	PS1-B-17	self tapping screw 2.6*6PBHC	9	
16	PS1-B-16	store display press block right	1	
15	PS1-B-15	Key support bar 1	1	
14	PS1-B-14	Socket hexagon cap screw M4.0*12H0	2	
13	PS1-B-13	self tapping screw 3*6PBHC	4	
12	PS1-B-12	No.1 battery jar bottom	1	
11	PS1-B-11	Machine tooth screws 2.5X4PWCETHZN	2	
10	PS1-B-10	HX710-AD board group	1	
9	PS1-B-9	positive spring	1	
8	PS1-B-8	negative spring	1	
7	PS1-B-7	dry battery cover	2	
6	PS1-B-6	lower cover	1	
5	PS1-B-5	Nut M4.0	1	
4	PS1-B-4	sealing cover	2	
3	PS1-B-3	Socket hexagon cap screw M4.0*12H0	4	
2	PS1-B-2	PS1 A/B storage battery cover	1	
1	PS1-B-1	sunk screw 2.6X8FBH0	4	
S/N	Code	Name	Num.	Remark

1.3 PS1XC

➤ Stainless steel platter

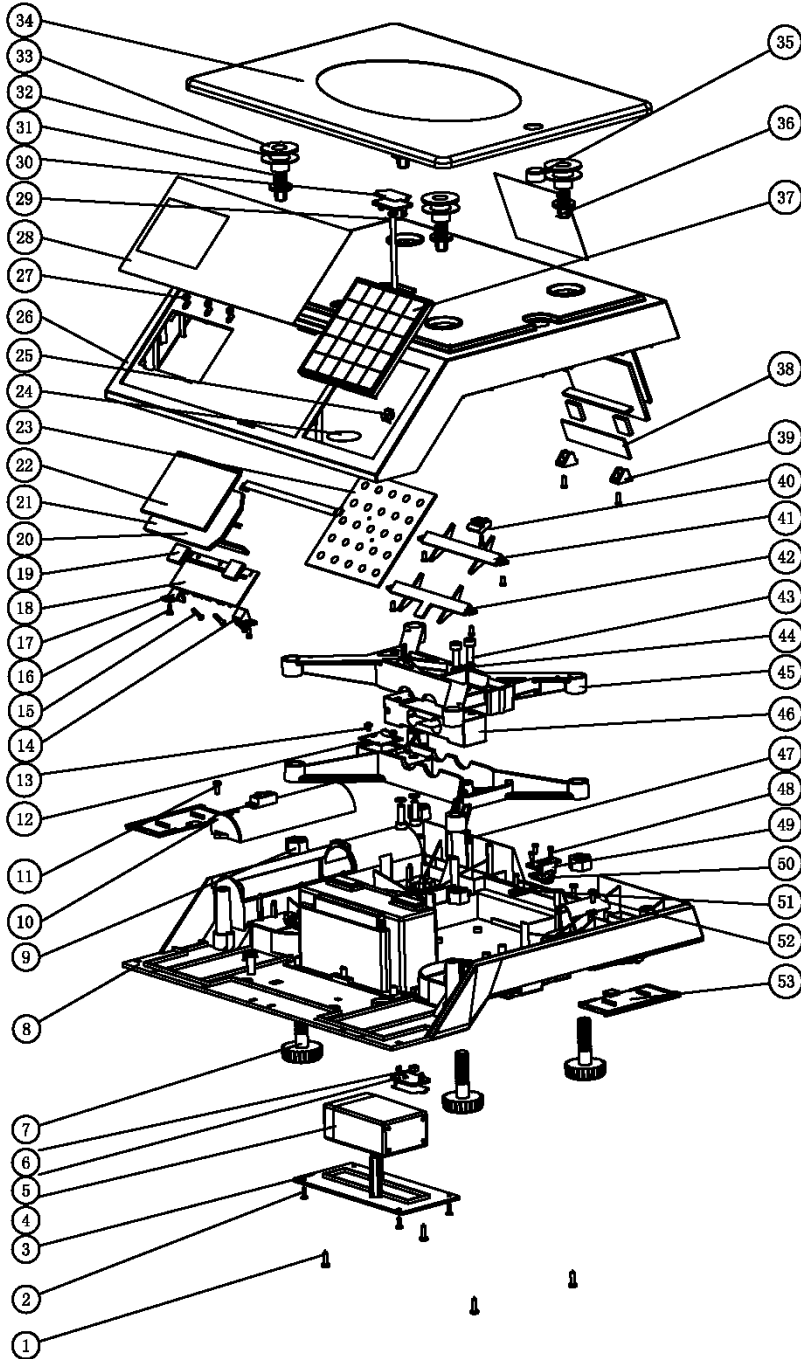

53	PS1-C-53	dry battery cover	2	
52	PS1-C-52	No.5 battery jar bottom	1	
51	PS1-C-51	PS1 RS232 press block	1	
50	PS1-C-50	communication board group	1	
49	PS1-C-49	PS1 USB press block	1	
48	PS1-C-48	self-tapping screw 2.6*6PBHC	4	
47	PS1-C-47	Socket hexagon cap screw M4.0*12H0	2	
46	PS1-C-46	sensor	1	
45	PS1-C-45	aluminum alloy post	2	
44	PS1-C-44	Spring washer M6.0	4	
43	PS1-C-43	Socket hexagon cap screw M6.0*25	4	
42	PS1-C-42	Key support bar 1	1	
41	PS1-C-41	Key support bar 2	1	
40	PS1-C-40	button press block	1	
39	PS1-C-39	customer display press block	2	
38	PS1-C-38	customer display board group	1	
37	PS1-C-37	silicon rubber button	1	
36	PS1-C-36	customer display	1	
35	PS1-C-35	gradienter	1	
34	PS1-C-34	stainless steel platter	1	
33	PS1-C-33	pan locating pin	4	
32	PS1-C-32	anti-insect slice 4	4	
31	PS1-C-31	Adjustable bolts	4	
30	PS1-C-30	Sealing fragile label	1	
29	PS1-C-29	Machine tooth screws M4.0X78FMHC	1	
28	PS1-C-28	Store display + back up plate	1	
27	PS1-C-27	hexagon nut M2.5	3	
26	PS1-C-261	Upper cover	1	
25	PS1-C-25	prevent cheating switch group	1	
24	PS1-C-24	Buzzer D27	1	
23	PS1-C-23	keyboard group	1	
22	PS1-C-22	LCD	2	
21	PS1-C-21	back light group	2	
20	PS1-C-20	Conductive rubber BYS79X8X2.5B-0.1	2	
19	PS1-C-19	PTI rubber pads	4	
18	PS1-C-18	Main board group	1	
17	PS1-C-17	store display press block right	1	
16	PS1-C-16	self-tapping screw 2.6*6PBHC	9	
15	PS1-C-15	Machine tooth screws 2.5X11PMHC	3	
14	PS1-C-14	store display press block left	1	
13	PS1-C-13	Machine tooth screws 2.5X4PWCTTHZN	2	
12	PS1-C-12	HX710-AD board group 2	1	
11	PS1-C-11	self-tapping screw 3*8PBHC	5	
10	PS1-C-10	No. 1 battery jar bottom	1	
9	PS1-C-9	hexagon nut M10	4	
8	PS1-C-8	Lower cover	1	
7	PS1-C-7	scale pads group	4	
6	PS1-C-6	Nut M4.0	1	
5	PS1-C-5	sealing cover	2	
4	PS1-C-4	Storage battery 4V2AH	1	
3	PS1-C-3	PS1 C/D storage battery cover	1	
2	PS1-C-2	sunk screw 2.6X8PBH0	4	
1	PS1-C-1	Machine tooth screws 3.0*12PCTTRHC	4	
S/N	Code	Name	Num.	Remark

1.4 PS1XD

➤ Stainless steel platter

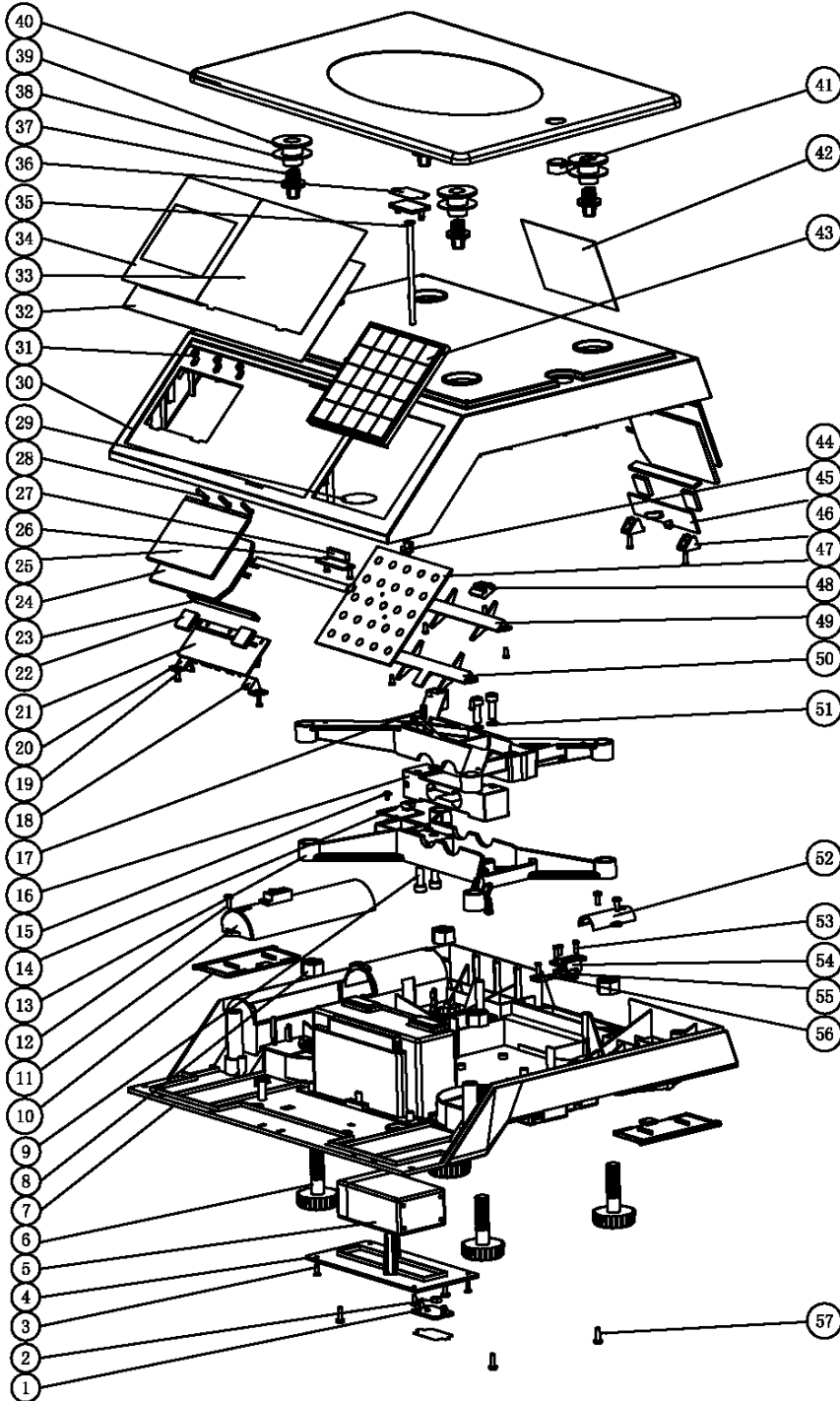

57	PS1-D-57	Machine tooth screws 3.0*12PCTTRHC	4	
56	PS1-D-56	PS1 RS232press block	1	
55	PS1-D-55	communication board 2	1	
54	PS1-D-54	PS1 USB press block	1	
53	PS1-D-53	Self-tapping screw 2.6*6PBHC	4	
52	PS1-D-52	No.5 battery jar bottom	1	
51	PS1-D-51	Spring washer M6.0	4	
50	PS1-D-50	Key support bar 1	1	
49	PS1-D-49	Key support bar 2	1	
48	PS1-D-48	button press block	1	
47	PS1-D-47	keyboard group	1	
46	PS1-D-46	customer display press block	2	
45	PS1-D-45	customer display board group	1	
44	PS1-D-44	prevent cheating switch group	1	
43	PS1-D-43	silicon rubber button	1	
42	PS1-D-42	customer display	1	
41	PS1-D-41	gradienter D14.8X8.3-60	1	
40	PS1-D-40	stainless steel platter	1	
39	PS1-D-39	pan locating pin	4	
38	PS1-D-38	anti-insect slice	4	
37	PS1-D-37	adjustable bolts	4	
36	PS1-D-36	sealing fragile label	1	
35	PS1-D-35	Machine tooth screws M4.0X78PMHC	1	
34	PS1-D-34	store display	1	
33	PS1-D-33	Buttons piece with color	1	
32	PS1-D-32	Buttons line piece	1	
31	PS1-D-31	hexagon nut M2.5with white zinc	3	
30	PS1-D-30	upper cover	1	
29	PS1-D-29	Buzzer D27	1	
28	PS1-D-28	Machine tooth screws 2.5X11PMHC	3	
27	PS1-D-27	Press rubber QS-23*6*3	1	
26	PS1-D-26	Mylar plate ROHS blue ink 3.4*1.1	1	
25	PS1-D-25	EVLCD-SDHM9756HP	2	
24	PS1-D-24	backlight group	2	
23	PS1-D-23	Conductive rubber BYS79X8X2.5B-0.1	2	
22	PS1-D-22	PTI rubber pads 15*15*T3	4	
21	PS1-D-21	Main board group	1	
20	PS1-D-20	store display press block left	1	
19	PS1-D-19	Self-tapping screw 2.6*6PBHC	11	
18	PS1-D-18	store display press block right	1	
17	PS1-D-17	Socket hexagon cap screw M4.0*12H0	2	
16	PS1-D-16	Nuosheng 20KG sensor LAB-C6A-20KG-B-2.0	1	
15	PS1-D-15	Machine tooth screws 2.5X4PCTTHAN (with washer06)	2	
14	PS1-D-14	HX710-AD board group 2	1	
13	PS1-D-13	aluminum alloy post 4	2	
12	PS1-D-12	dry battery cover	2	
11	PS1-D-11	Self-tapping screws 3*6PBHC	5	
10	PS1-D-10	No.1 battery jar bottom	1	
9	PS1-D-9	Socket hexagon cap screw M6.0*25 (GB70-85)	4	
8	PS1-D-8	hexagon nut M10 (GB41-85)	4	
7	PS1-D-7	lower cover	1	
6	PS1-D-6	scale pads group	4	
5	PS1-D-5	Storage battery 4V2AH	1	
4	PS1-D-4	storage battery cover	1	
3	PS1-D-3	sunk screws 2.6X8PBH0	4	
2	PS1-D-2	Nut M4.0	1	
1	PS1-D-1	sealing cover	2	
S/N	Code	Name	Num.	Remark

1.1 PS1XD-Pole

➤ Stainless platter

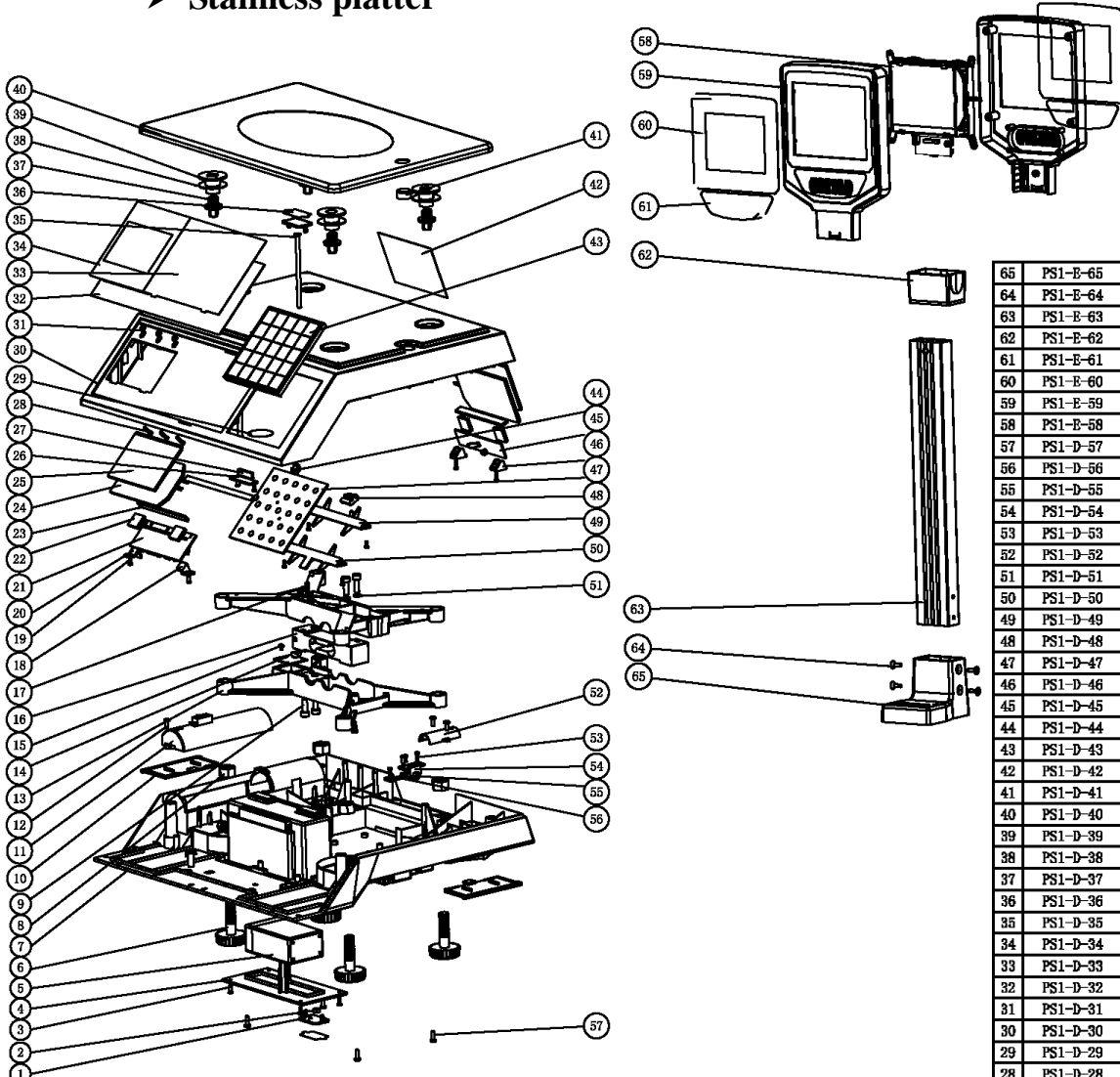

65	PS1-E-65	Display connector	1	
64	PS1-E-64	Sunk machine tooth 4.0*9PCTTRHC	4	
63	PS1-E-63	Display pole	1	
62	PS1-E-62	Display box lock	1	
61	PS1-E-61	Voice panel	2	
60	PS1-E-60	display panel	2	
59	PS1-E-59	display box	2	
58	PS1-E-58	display module	1	
57	PS1-D-57	Machine tooth screws 3.0*12PCTTRHC	4	
56	PS1-D-56	PS1 RS232press block	1	
55	PS1-D-55	communication board 2	1	
54	PS1-D-54	PS1 USB press block	1	
53	PS1-D-53	Self-tapping screw 2.6*6PWHC	4	
52	PS1-D-52	No.5 battery jar bottom	1	
51	PS1-D-51	Spring washer M6.0	4	
50	PS1-D-50	Key support bar 1	1	
49	PS1-D-49	Key support bar 2	1	
48	PS1-D-48	button press block	1	
47	PS1-D-47	keyboard group	1	
46	PS1-D-46	customer display press block	2	
45	PS1-D-45	customer display board group	1	
44	PS1-D-44	prevent cheating switch group	1	
43	PS1-D-43	silicon rubber button	1	
42	PS1-D-42	customer display	1	
41	PS1-D-41	gradienter D14.8X8.3-60	1	
40	PS1-D-40	stainless steel platter	1	
39	PS1-D-39	pan locating pin	4	
38	PS1-D-38	anti-insect slice	4	
37	PS1-D-37	adjustable bolts	4	
36	PS1-D-36	sealing fragile label	1	
35	PS1-D-35	Machine tooth screws M4.0X7.8FPHC	1	
34	PS1-D-34	store display	1	
33	PS1-D-33	Buttons piece with color	1	
32	PS1-D-32	Buttons line piece	1	
31	PS1-D-31	hexagon nut M2.5with white zinc	3	
30	PS1-D-30	upper cover	1	
29	PS1-D-29	Buzzer D27	1	
28	PS1-D-28	Machine tooth screws 2.5X11PMHC	3	
27	PS1-D-27	Press rubber QS-23*6*3	1	
26	PS1-D-26	Mylar plate ROHS blue ink 3.4*1.1	1	
25	PS1-D-25	EVLCD-SDHM9755HP	2	
24	PS1-D-24	backlight group	2	
23	PS1-D-23	Conductive rubber BVS79X8X2.5B-0.1	2	
22	PS1-D-22	PTIrrubber pads 15*15*T3	4	
21	PS1-D-21	Main board group	1	
20	PS1-D-20	store display press block left	1	
19	PS1-D-19	Self-tapping screw 2.6*6PWHC	11	
18	PS1-D-18	store display press block right	1	
17	PS1-D-17	Socket hexagon cap screw M4.0*12HO	2	
16	PS1-D-16	Nuoheng 20KG sensor LAB-05A-20KG-B-2.0	1	
15	PS1-D-15	Machine tooth screws 2.6XAPCTTRHAN (with washer06)	2	
14	PS1-D-14	HX710-AD board group 2	1	
13	PS1-D-13	aluminum alloy post 4	2	
12	PS1-D-12	dry battery cover	2	
11	PS1-D-11	Self-tapping screws 3*6PWHC	5	
10	PS1-D-10	No.1 battery jar bottom	1	
9	PS1-D-9	Socket hexagon cap screw M6.0*85 (GRYD-85)	4	
8	PS1-D-8	hexagon nut M10 (GB41-85)	4	
7	PS1-D-7	lower cover	1	
6	PS1-D-6	scale pads group	4	
5	PS1-D-5	Storage battery 4V2AH	1	
4	PS1-D-4	storage battery cover	1	
3	PS1-D-3	sunk screws 2.6X8FPHO	4	
2	PS1-D-2	Nut M4.0	1	
1	PS1-D-1	sealing cover	2	
S/N	Code	Name	Num.	Remark

2 ERROR CODE WARNING

ERROR ‘HLb’ : when the battery voltage is in warning voltage (3.1 V) and screen displays ‘HLb’ words , which means current electricity is about to ran out and can last a very short time .

ERROR ‘LLb’: when the battery voltage is in power off voltage (2.9V, scale will power off itself automatically when screen displays ‘LLb’ words.

When the scale is in power on status and screen displays ‘LLb’ words accompanied by tick sound and then power off automatically. which means scale is out of work already and is needed to change battery immediately.

3 SEALING OPERATION METHOD and ACCELERATION of GRAVITY ADJUSTMENT

Gravity acceleration compensation value can’t be adjusted directly after the PS1X price computing scale adopts sealing protection. If needs to adjust the gravity acceleration, you must destroy the sealing.

Our company adopts environmental label sealing, only needs to destroy the fragile label sealing to startup the amending mode, do not need to disassemble the cover.

The operating steps of adjusting the acceleration of gravity A/D value and Zero full weight learning are as follows:

3.1 Destroy the sealing



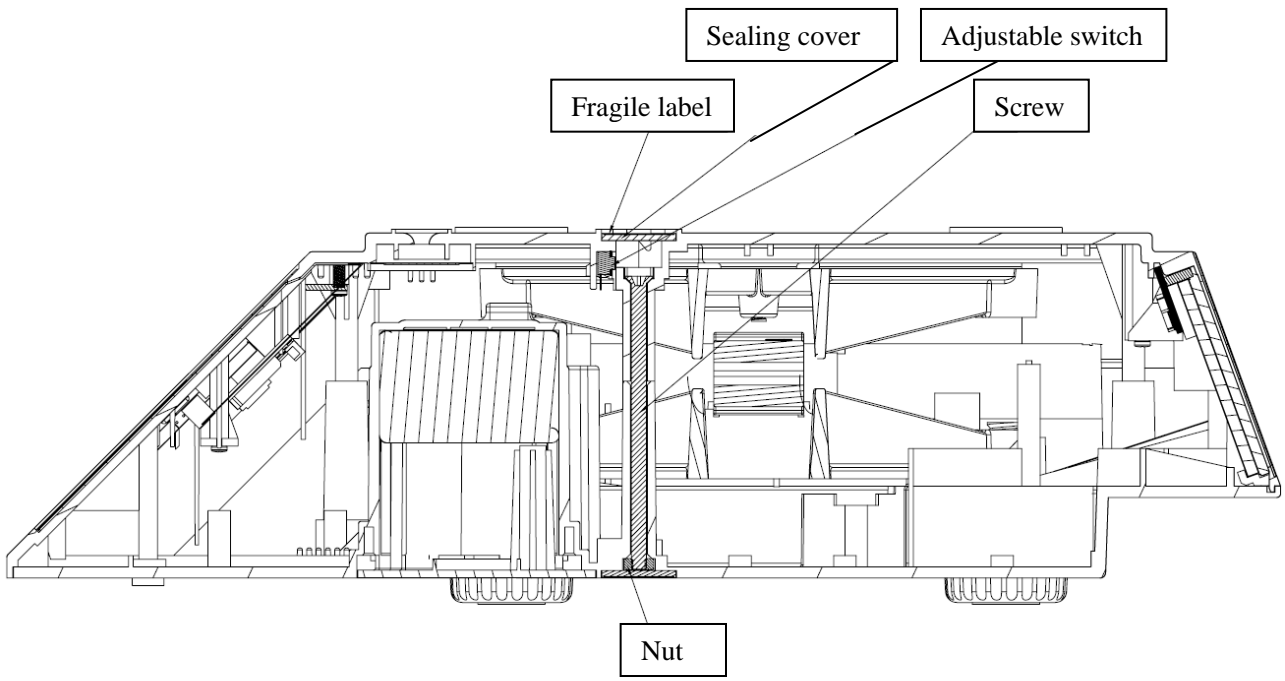
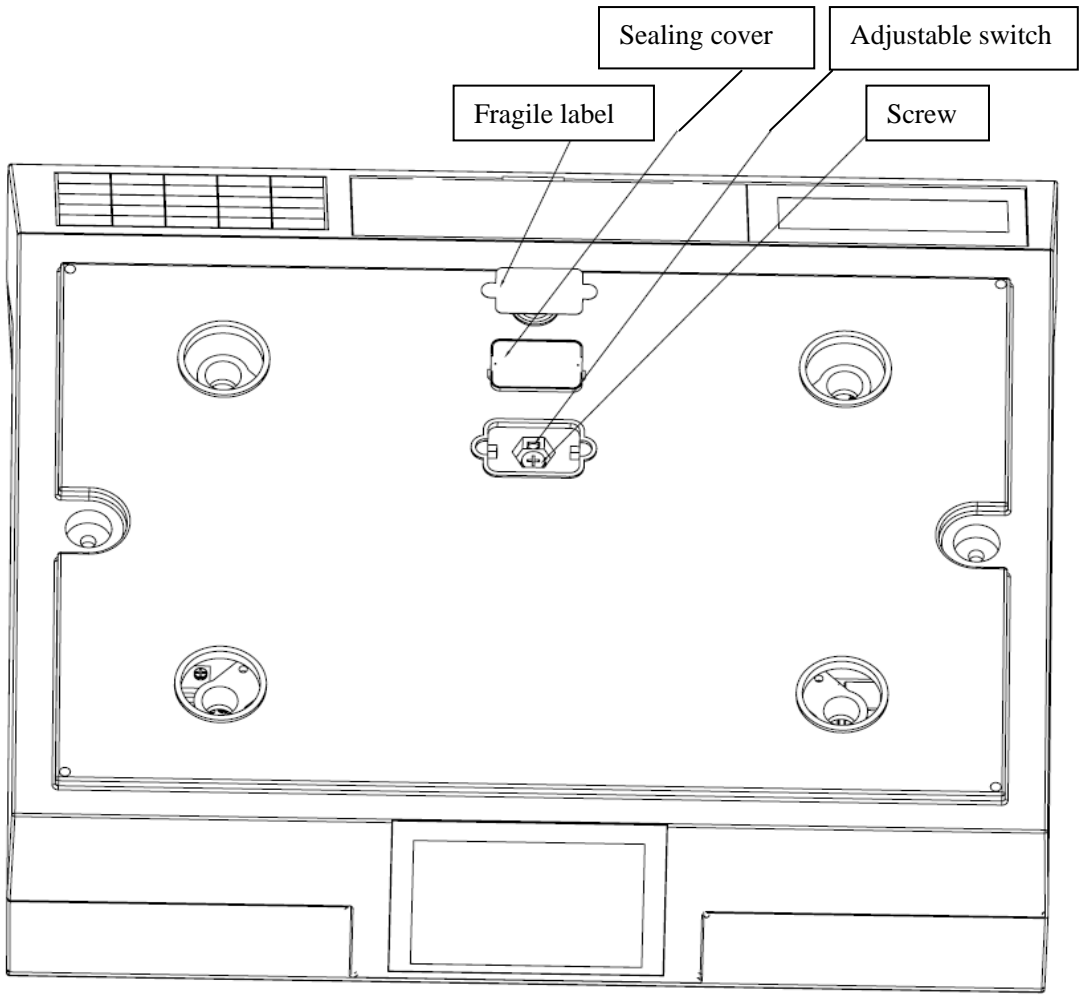

- 1) Destroy the fragile label sealing
- 2) Open the plastic sealing cover.
- 3) Only use the sharp-pointed instrument such as pen point to touch the adjustable switch lightly can adjust the acceleration of gravity A/D value and zero full weight learning.
- 4) What you need to do is breaking the label based on the adjustment and do not need to open case. The label sealing must be broke if you want to open the case. Please take the below pictures as you references.





3.2 The methods of gravity acceleration compensation value adjustment

Please follow below steps to amend the gravity acceleration compensation value and there are two methods to reach value adjustment.

Manual adjustment:

- 1) Press the key  to start up the scale
- 2) Take off the platter
- 3) Destroy the label sealing, startup the switch
- 4) Put the platter on the scale again
- 5) Press  key first to make sure the scale weight is zero, the screen will display 00.000kg, and then put full weight on platter according to measuring range, eg :30Kg weight. If the weight displayed on the screen is not correct, please press  or  key to adjust till the digit is right.

Automatic adjustment:

- 1) Press the key  to start up the scale
- 2) Take off the platter
- 3) Destroy the label sealing, startup the switch
- 4) Put the platter on the scale again
- 5) Please make sure there is nothing on the platter, and the screen will display 00.000kg. then please put full weight on the platter, if the weight displayed on the screen is not full weight, please press the key  to auto-adjust. At this time you will hear a long sound “beep” and the screen will display full weight.

3.3 The methods of label sealing after amending

The price computing scale needs to be sealed again after amending the gravity acceleration compensation value; the specific steps are as follows:

- 1) Close the plastic cover.
- 2) Paste a new fragile label sealing.

4 ZERO/FULL WEIGHT LEARNING METHODS

- 1 Press the power key to start up the scale, until in weighing mode.
- 2 Input number [1377].
- 3 Destroy the sealing (**chapter 3.1**) and press the green adjustable switch.
- 4 Please make sure the platter is in horizontal and there is no object on platter.
- 5 Input number [2400128], press [CHG] key to confirm. It will set the range as 15kg.
Input number [2400192], press [CHG] key to confirm. It will set the range as 30kg.
- 6 Press the key [M1] continuously for two times, at this time you can hear a long sound 'beep' which means the zero weight learning is successful. The weight column will display 0.000.
- 7 Put the full weight on the platter.
- 8 Press the key [M2] continuously for two times, at this time you can hear a long sound 'beep' which means full weight learning is successful. The weight column will display the full weight 15.000 or 30.000 (depends on the setting on step 5 above).
- 9 Put any weight on the platter to check whether the zero/full learning is successful or not.
- 10 Restart the machine to exit factory mode

